



Sample Garden Design:

Part Shade Kit

KEY:

1. Wild Columbine
(*Aquilegia canadensis*)
2. White Snakeroot
(*Ageratina altissima*)
3. Common Wood Sedge
(*Carex blanda*)
4. Blue Mistflower
(*Conoclinium coelestinum*)
5. Big-leaved Aster
(*Eurybia macrophylla*)
6. Bottlebrush Grass
(*Hystrix patula*)
7. Rough-leaved Goldenrod
(*Solidago rugosa*)
8. Heart-leaved Aster
(*Symphotrichum cordifolium*)
9. Ohio Spiderwort
(*Tradescantia ohiensis*)
10. Golden Alexanders
(*Zizia aurea*)

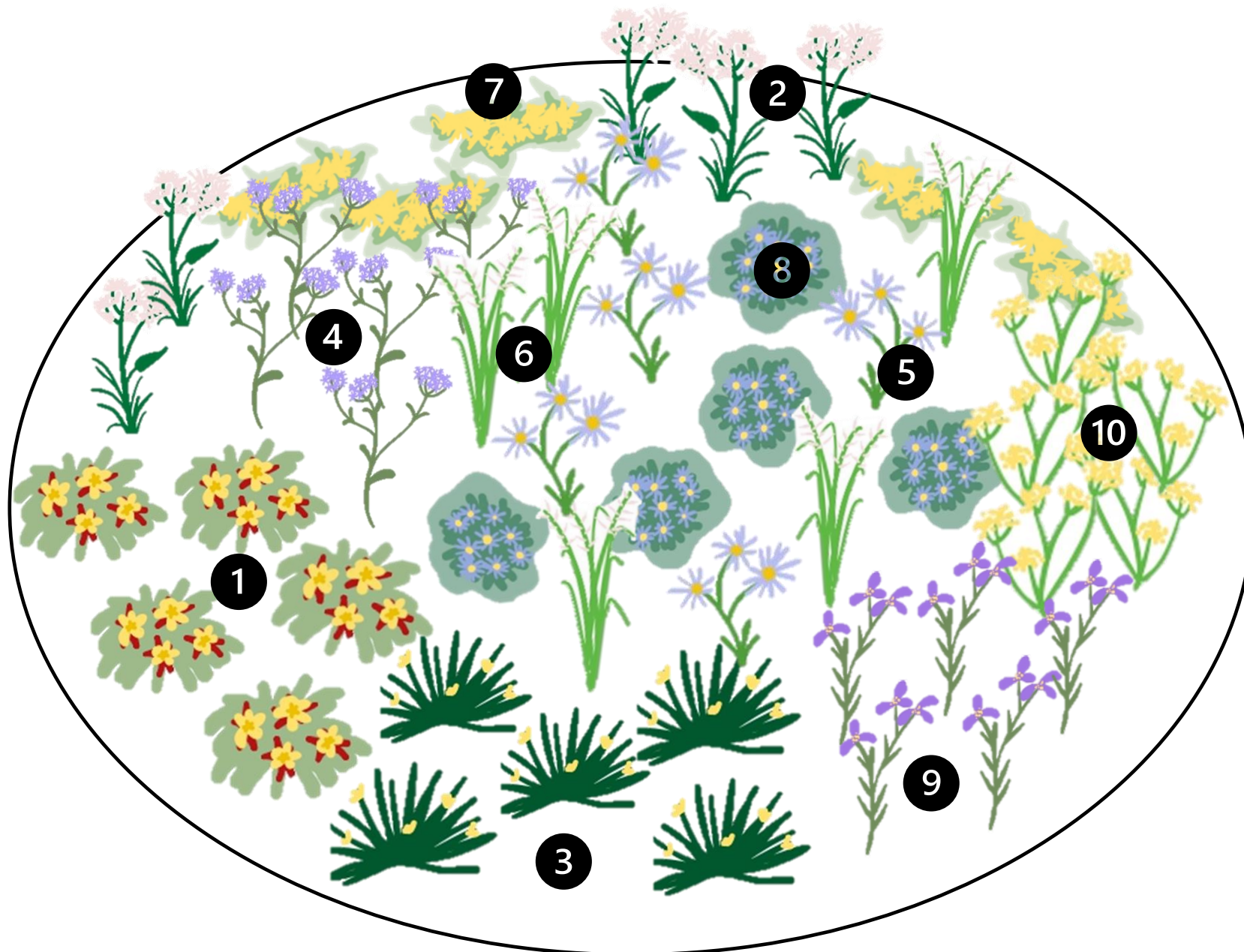

FRONT

*100 sq. foot plot

Substitutes: Nodding Wild Onion (*Anemone virginiana*), Northern Sea Oats (*Chasmanthium latifolium*), Wild Geranium (*Geranium maculatum*),

Broad-leaved Goldenrod (*Solidago flexicaulis*)

Updated 2024